

# MODU DATA CARD

West Phoenix

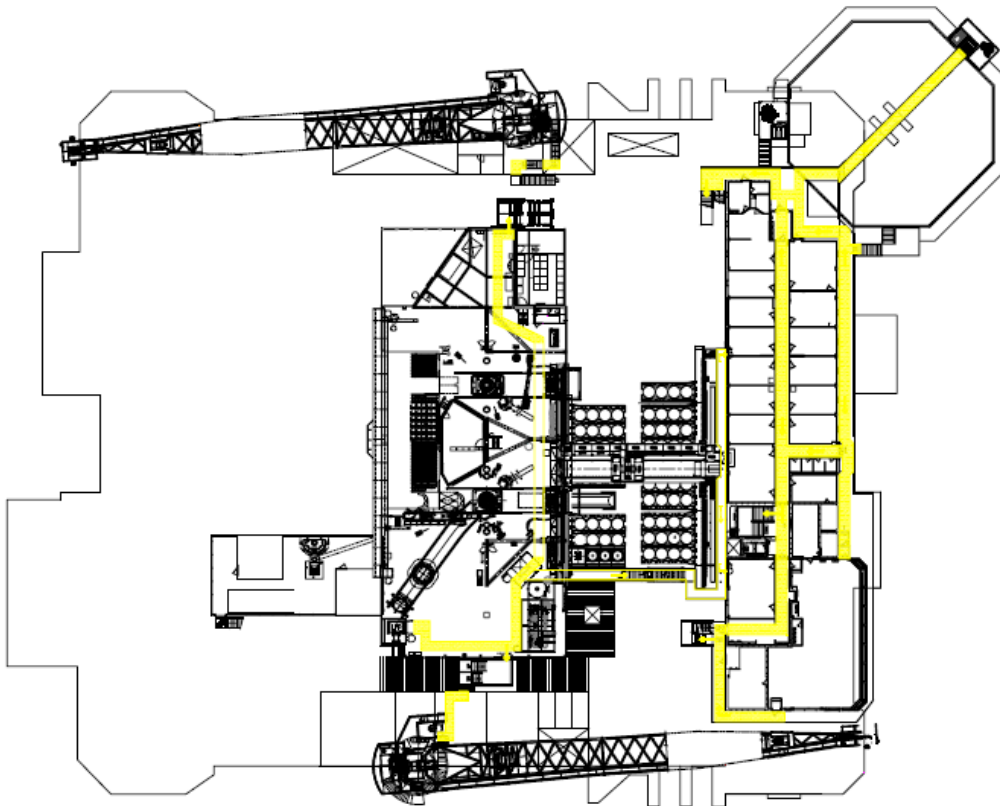

WHEEL HOUSE DECK / DRILL FLOOR

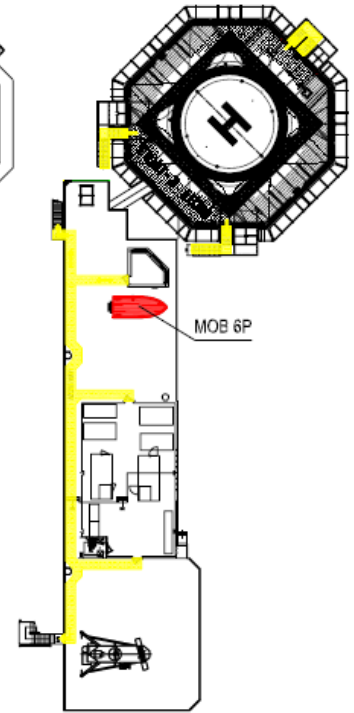

TOP OF WHEEL HOUSE

# MODU DATA CARD

West Phoenix

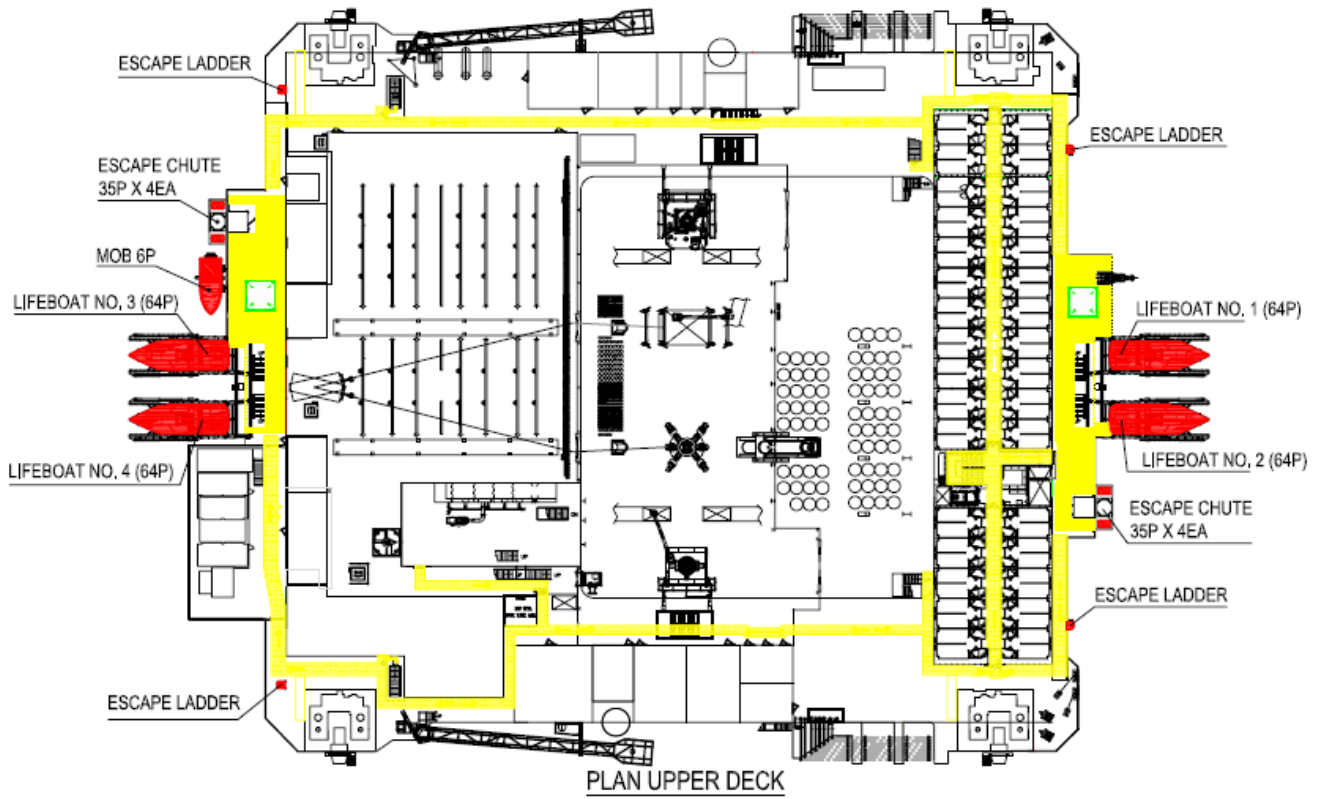

# MODU DATA CARD

West Phoenix

|                  |                 |                     |                            |
|------------------|-----------------|---------------------|----------------------------|
| <b>Block No.</b> | Balderbå 6604/5 | <b>Call Sign</b>    | 3ETB9                      |
| Latitude:        | N 66°35.6'      | <b>Rig Heading:</b> | Variable (Call the Bridge) |
| Longitude:       | E 004°32.9'     | <b>Water depth:</b> | 1219 meters                |

| <b>Anchors</b> | Bearing (T) | Scope of Chain | Touch Down Point | Anchor Dist From Rig (Mtr.) |
|----------------|-------------|----------------|------------------|-----------------------------|
| 1              |             |                |                  |                             |
| 2              |             |                |                  |                             |
| 3              |             |                |                  |                             |
| 4              |             |                |                  |                             |
| 5              |             |                |                  |                             |
| 6              |             |                |                  |                             |
| 7              |             |                |                  |                             |
| 8              |             |                |                  |                             |

NO ANCHORS

| <b>Communications</b> | General         | Emergency       | St.by boat: TBC |
|-----------------------|-----------------|-----------------|-----------------|
| VHF                   | Ch. TBC         | Ch. 16          | Ch. 16 / TBC    |
| Telephone             | +47 52 88 77 00 | +47 52 88 77 77 | + 44 1224459643 |
| Other                 |                 |                 |                 |

| <b>Cranes</b> | Port | SWL/Radius | Stbd. | SWL/Radius |
|---------------|------|------------|-------|------------|
| Whip          |      | 17t/50m    |       | 17t/50m    |
| Main Block    |      | 80t/20m    |       | 80t/20m    |

| <b>General information</b>                 |  |
|--|--|
| Type of rig:                               | Semi Submersible Drilling Rig with Dynamic Positioning system. |
| Other installations with relative position |  |

| <b>Hose size and connections</b> |                  |        |         |           |                  |  |
|----------------------------------|------------------|--------|---------|-----------|------------------|--|
| Fuel Oil                         | 4" Avery hardoll | Cement | 5" Weco | Pot.water | 4" Weco          |  |
| Drill water                      | 4" Weco          | Barite | 5" Weco | Mud       | 4" Avery Hardoll |  |

| <b>Before arrival</b>  |
|--|
| Before arrival at the installation the Master and Watch Keeping Mates should read and understand the relevant sections of the "GOMO Guidelines" and "Instructions to Master - Supplement to GOMO and Operations manual for offshore vessels working on NCS" (Wintershall Norge AS) |

| <b>Pre-arrival Checks</b>  |        |          |
|--|--------|----------|
| Supply Vessel / AHTS to confirm to the installation  | Yes/No | Comments |
| The Master & Wachkeeping Mates are fully aware of the procedures for vessel entry. (Steering offset course, speed, manouvering etc.) |        |          |
| Main engines: Tested ahead and astern  |        |          |
| Steering Gear: Fully functional,(both main & emergency) and confirmed to be fully operational.                                       |        |          |
| Joystick: Function tested and confirmed to be fully functional.  |        |          |
| Communications: UHF/VHF radiocheck with crane, controll room, deck   |        |          |
| FRC's, Daughter Craft, mechanical recovery equipment and all other rescue equipment in good working order.                           |        |          |
| The weather conditions are suitable for the proposed operation.  |        |          |
| Vessel master to record completion of checks in deck Log Book  |        |          |

# MODU DATA CARD

West Phoenix

| Pre-arrival Checks   |        |  |
|--|--------|--|
| Installation to confirm to the Supply Vessel   | Yes/No | Comments                               |
| Deck crane, control room comms have been tested satisfactory.                              |        |  |
| Correct communications channels being used   |        |  |
| Confirm to the SBV that Supply vessel or Anchor handling Operations are about to commence. |        |  |
| The rig is ready to receive cargo or commence anchor handling operations.                  |        |  |
| Rig to record in log book time checklist completed and by whom                             |        | Time: _____ Date: _____<br>Name: _____ |

| Marine Hazards              |
|-----------------------------|
| There is a 500m safety zone |

| Bulk Cargo Transfer / Anchor Handling  |
|--|
| Prior to and during operations:  |
| Establish Comms between vessel/s and the platform  |
| Pressure test all hoses which have a potential to harm the environment - TSF & procedures  |
| Confirm that the crew are able to work in present weather conditions   |
| Confirm there is adequate lighting for the operation in hand   |
| Confirm that the vessels tanks/handling equipment are prepared for the proposed operation  |
| Confirm the crew are briefed fully on the operation/s to take place (Product to transfer/cargo to handle/anchor operation)         |
| Agree quantities/product/rates of discharge/pressures/ OR anchor/pennant/chain/buoy number   |
| Confirm hose length available  |
| Confirm who will stop cargo transfer at agreed quantities  |
| The hose must be visible to the master at all times during transfer. If not a crewmember will act standby man with suitable comms. |
| All transfers must begin slowly and only increase in rate once integrity has been proved.  |
| Confirm on a regular basis quantities and progress of any operation with the vessel.   |

## Alarms

### General Alarm:

Sound: - - - - - Intermittent audible signal of Constant frequency (1sec on, 1sec off)

Light:  Yellow flashing or rotating Visual lamp

### Prepare evacuation:

Sound:  Continuous audible signal of Equal frequency

Light:  Yellow flashing or rotating Visual lamp

### Gas Alarm:

Sound: ----- Intermittent audible signal (0.1sec on, 0.1sec off)

Light:  Red flashing or rotating Visual lamp