

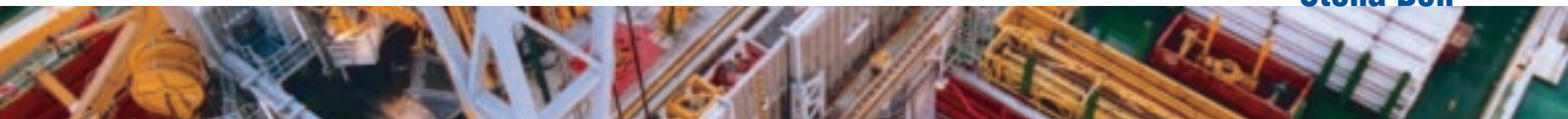

Stena Don

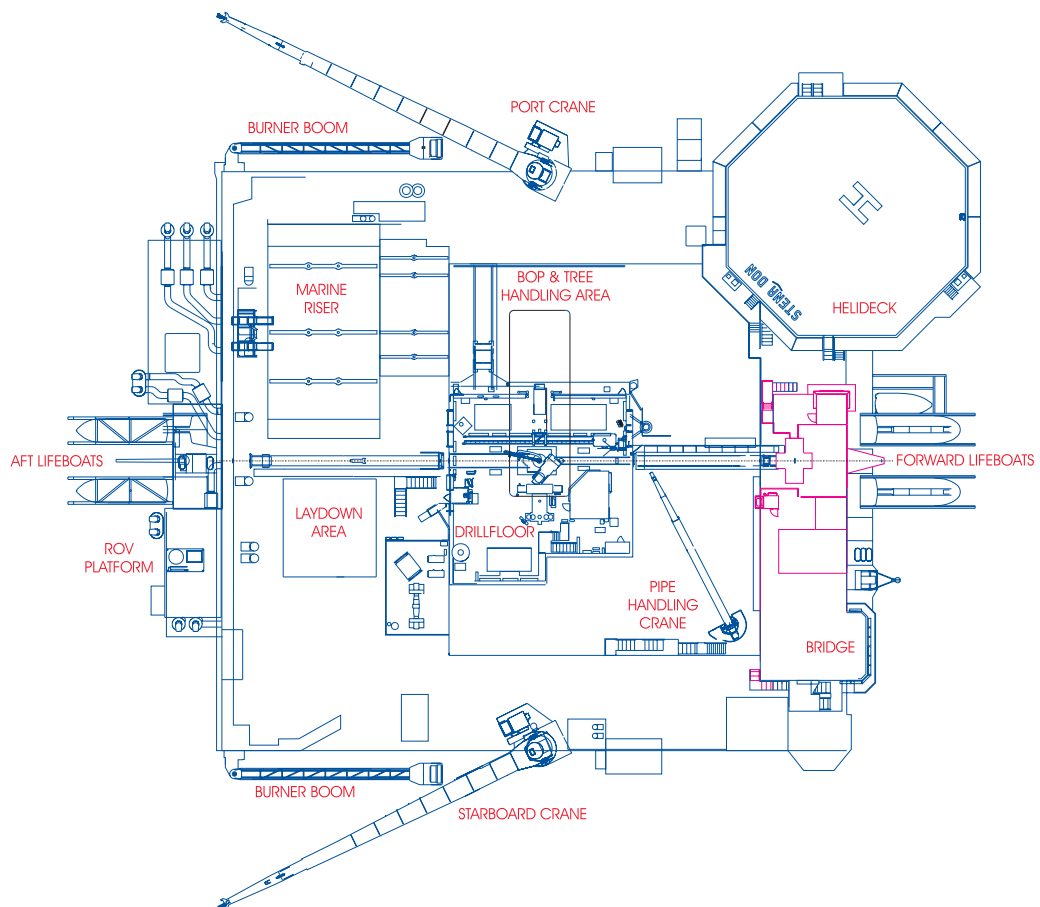

GENERAL DESCRIPTION

Stena Don is a dynamically positioned (class 3), harsh environment semi-submersible drilling, completion and workover vessel for worldwide operations.

The drilling unit is presently outfitted for drilling operations in water depths from 130 to 500 mts. Deeper water operations are achievable through additional subsea equipment.

The dynamically positioned vessel is equipped with a hydraulic drilling package and complies with current Norwegian regulations.

PRINCIPAL CHARACTERISTICS

Length:	72.25m (deck)
Breadth:	67.00m (deck)
Depth:	33.50m (keel to main deck)
Columns:	6 total (4 corner 11.2m x 10m and 2 centre 6.5m x 7.25m)
Pontoons:	2 (95.50m length, 13m / 8m breadth, 12.5m / 10.5m deep)
Deck Area:	72.25m x 67.00m

Draft

Operating:	21.50m
Transit:	11.50m/12m
Survival:	18.50m

Displacement

Operating:	33,000 tonnes
Transit:	23,100 tonnes

Deck Loads

Operating:	3,900 tonnes
Transit:	3,500 tonnes

Transit Speed	8 knots
----------------------	---------

CLASSIFICATION

DNV: +1A1, Column Stabilised Drilling Unit, DRILL (N), Structure (N), EO, DYNPOS AUTRO, CRANE, HELDK

ACCOMMODATION

Living quarters for 102 persons
8 Offices
Hospital
Gymnasium/Aerobics Room
Sauna

STORAGE CAPACITIES

Liquid Mud:	630 m ³ (surface pits) 400 m ³ (column tanks)
Bulk Mud/Cement:	8 bulk tanks, total capacity 470 m ³
Sacks:	2000 sacks
Drillwater:	900 m ³
Potable Water:	520 m ³
Fuel Oil:	2,800 m ³
Others:	Base oil 260 m ³ Brine 640 m ³ Slop tanks 200 m ³

DYNAMIC POSITIONING SYSTEM

Kongsberg Simrad	
Main DP:	SDP 21
Back up:	SDP11
Ref System:	2 x HPR 418 2 x DGPS 2 x Taut Wires

CRANES

2 off Hydralift Knuckle Boom Cranes type OKMCVC 4000

Maximum lift 85mt at 15 metres
Maximum lift 15mt at 45 metres

1 off Hydralift Pipe Handling Crane 5.5 tonnes max outreach 22 metres.

POWER SUPPLY

9 X Wartsila type 16v25-3500 kW (total 31,500 kW)
Siemens Power System
11kV / 690V / 440V / 240V 60Hz
Siemens IAS + Power Management

PROPULSION

6 x Kamewa Aqua Master (Variable Speed)
Azimuth Thruster UUC 5001 3300kW (total 19,800 kW or 360 tonnes thrust), Propeller diameter 3500mm

DRILLING EQUIPMENT

DRILLERS CONTROL SYSTEM

Derrick:	Set back 600mt, free height 36m, racking 192 std's 7" tubing, 210 stands 5 1/2 DP 3 x Hydraulic lifting cylinders 680 mt capacity
-----------------	--

Control Systems:	Hydralift/Hitec
-------------------------	-----------------

Rotary:	Wirth 6050 hydraulic, 60 1/2", 48,000 ft/lbs, 0-50 RPM
----------------	--

Top Drive:	Hydralift AC drive, 680 mt, 0-280 RPM, 67,000 ft/lbs torque
-------------------	---

Pipe Handling:	Hydracker (2 arm pipe handler) on drill floor remote operated pipe handling crane on pipe deck
-----------------------	--

Stand Building:	Offline using iron roughneck, hydra racker and catwalk
------------------------	--

Guidelines Tensioners:	4 Telescopic G/line tensioners 40' line travel, 7.5 mt capacity
-------------------------------	---

Motion Compensators:	Hydralift active heave compensator 7.6m stroke, 300mt, mounted on drillfloor
-----------------------------	--

Mud Pumps:	3 x Continental Emsco FC-2200hp
-------------------	---------------------------------

Mud Control System:	Hitec SMIC System
----------------------------	-------------------

Shale Shakers:	4 x Derrick Flo-line 2000 c/w Cuttings Conveyor for big bag handling
-----------------------	--

Degasser:	Burgess Magnavac
------------------	------------------

Cementing Unit:	Halliburton 15,000 psi Model HCS25E Advantage
------------------------	---

Drillpipe:	5,000m 5" S135 Range 2, 4,000m 3 1/2" S135 Range 2 18 x HWDP, 5"
-------------------	--

Drillcollars:	30 x 4" 24 x 6 1/2" 18 x 8"
----------------------	-----------------------------------

Casing Handling:	Weatherford
-------------------------	-------------

SUBSEA EQUIPMENT

BOP:	Cameron 18 3/4" 15,000 psi WP "TL" BOP Stack Guideline/Guideline-less System
-------------	--

BOP Handling:	320 mt Hydraulically Operated Trolley (Well Center to BOP Setback) 320 (2 x 160 mt) Ton Bridge Crane with 2 x 30 mt Service Crane fitted with Hydraulic BOP Guiding Structure
----------------------	--

Control System:	Cameron 5,000psi Closed Loop Electro-Hydraulic Sub-sea BOP Multiplex Control SystemRiser
------------------------	--

Riser:	Cameron 21" LK 2.0 / RF 25 x 65' joints Two (2) 15,000 psi - 5" x 3" Choke & Kill Lines One (1) 5,000 psi - 5.5" x 4.5" - Boost Line Two (2) 5,000 psi - 5" x 4" Hydraulic Lines
---------------	--

Telescopic Joint:	Cameron LK 2.0 / RF 55' ft Stroke
--------------------------	-----------------------------------

Riser Tensioners:	4 Double tensioners 15.24m stroke, 73 mt x 2
--------------------------	--

Choke & Kill:	Cameron Choke & Kill Manifold, 3 1/8" API - 15,000 psi x 4 1/8" API - 10,000 psi
--------------------------	--

Diverter:	ABB Vetco Gray 60.50, KFDS / CSO
------------------	----------------------------------

TV System:	Hernis
-------------------	--------

Positioning:	LMRP / Riser Mounted Riser Angle
---------------------	----------------------------------



Stena Don

www.stena-drilling.com