

Platform Name:

Kvitebjørn



Contact Information

Call sign:	LF7A	E-mail:	kvbskr@equinor.com
MMSI no:	259 06 400	Phone no:	+47 565 42 212
Position datum WGS 84 North, dms:	61°4'47,3"	VHF central control room:	69
Position datum WGS 84 East, dms:	2°29'52,76"	UHF central control room:	1

Contact Information cranes

UHF crane 1 north	7	UHF crane 3	na
UHF crane 2 south	8	UHF crane 4	na

Map with zones (not to scale)

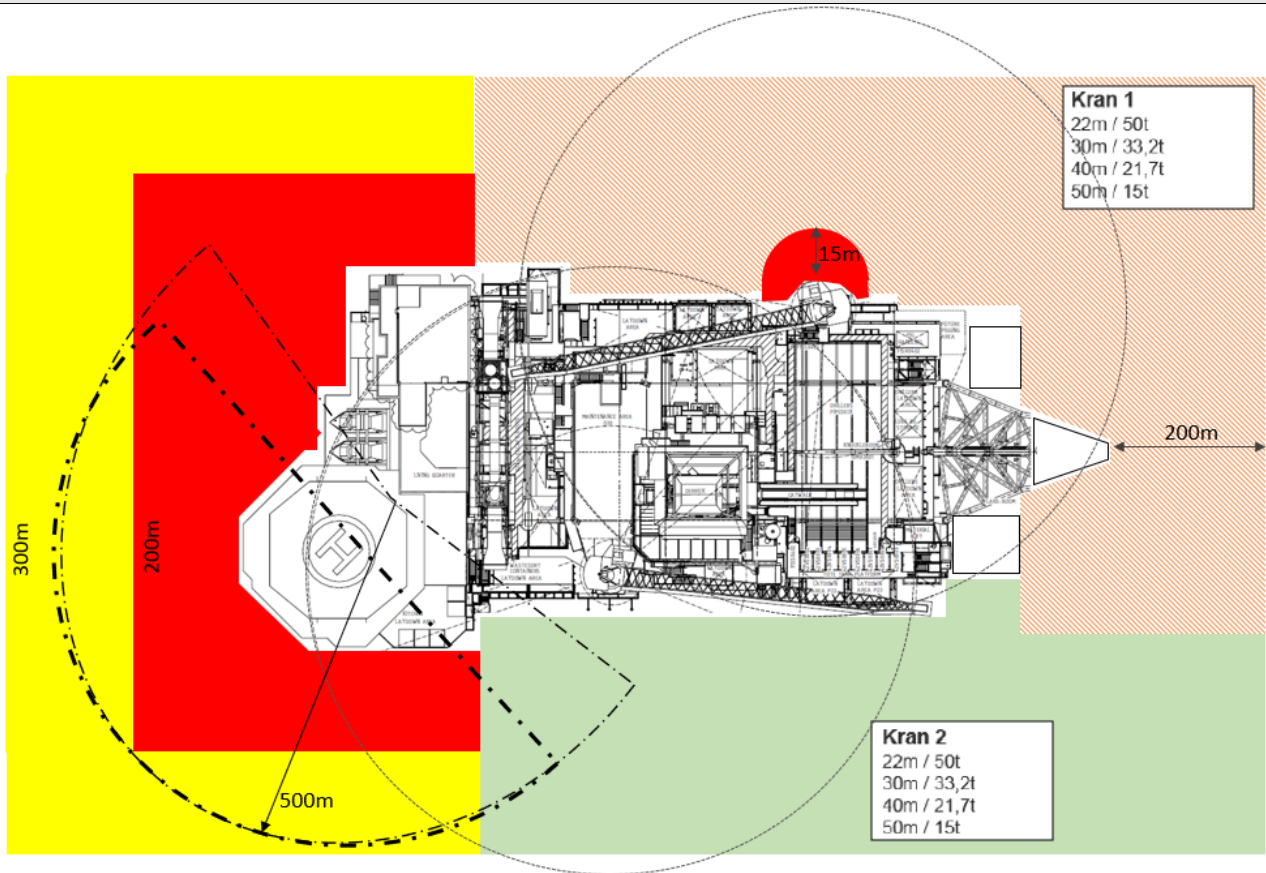

Zone color coding

Color	Meaning	Reason
Green zone:	Loading/offloading zone. Normal process with approval from the Central Control room	Crane on south side to be used to avoid the exposed risers on the north side
Orange-striped zone:	Entering this zone needs extra approval from Platform Manager in addition to Central Control room	At north side: Exposed hydrocarbon riser 21m above MSL At flare boom side: Risk of falling objects, high temperatures, and hot particles from flaring. The flare line could also be exposed to collision on the east side
Red/Yellow zone:	Exclusion zone. Entering this zone needs approved dispensation.	At north side: Exposed hydrocarbon riser 21m above MSL On the west side / living quarter side: Low hanging living quarter and life boat structure. The living quarter is hanging, and the consequences of a ship collision could be severe.

Other symbols/markings



180-degree obstacle free helicopter zone
 210-degree obstacle free helicopter zone
 Overboard discharges

Platform specific information

Largest allowed vessel displacement for normal visit:

8000t

Lowest height from MSL to living quarter or lifeboats:

22m to pipeline on north side (see additional information below)
 24m to living quarter and lifeboat structure

Lowest bridge height from MSL:

na

Displacement / Significant wave height -table for vessel operation on lo-ward side of platform

E = 14 MJ	
Deplasement [ton]	Significant wave height [m]
4000	4.5
4500	4.2
5000	4.0
5500	3.8
6000	3.7
6500	3.5
7000	3.4
7500	3.3
8000	3.2
8500	3.1
9000	3.0
9500	2.9
10000	2.8



Additional information

Height limitations:

- Any exeptions from ships taller than 21m should be cleared with the platform manager.
- Suggested compensating measures for vessels taller than 21m:
 - Limit the maximum allowed wave height
 - Limit the amount of time the vessel is in the safety zone
 - The vessel should be on the leward side of the platform
 - Be aware of the tide (high or low during the vessel operation)
 - Risk assessment and approval from platform manager

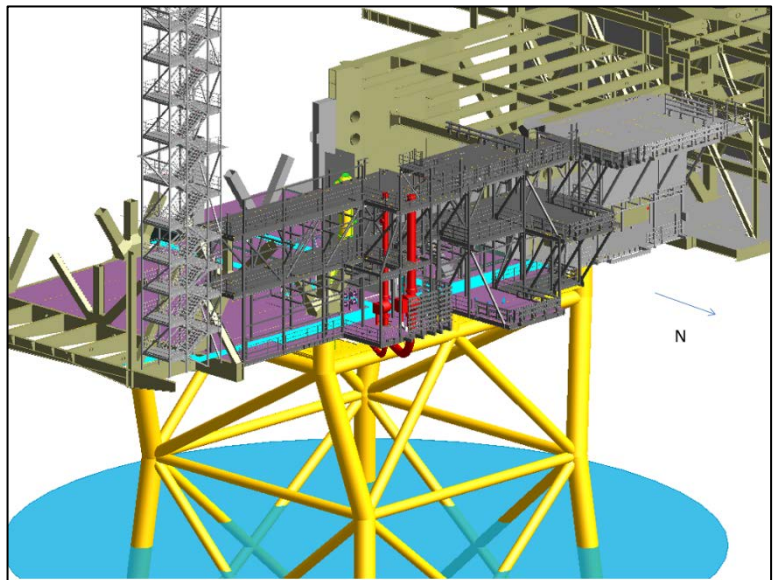

Owner: Marine Technology Department Equinor

Rev. No	Date	Name
0	25.02.2020	koksh